

Håndtak sidedør / handle side door

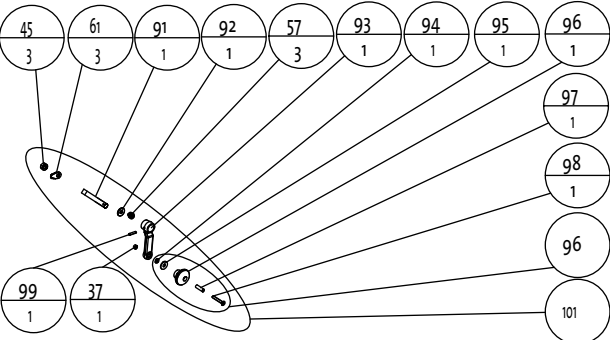

Del-liste/Part list Jøtul F 600

Jøtul AS Fredrikstad, Norway	Drawing no. 3-2715-Po3	Date: 17.09.2020
---------------------------------	---------------------------	---------------------

Jøtul F 600 Versjon 3

Jøtul F 600 BP cat.no. 350775, BBE-cat.no. 350776, OGE-cat.no. 350777, IVE-cat.no. 350778, GRE-cat.no. 350931, BRM- cat. no. 351111, BLM-cat nn.351126

Antall Number	Pos. nr Item no	Reservedeler Spareparts	Consist of pos no.	Benevnelse	Description	Dim./Spec.
1	2	155766		Rørrammeholder	Tube frame holder	Cast iron, min.4mm thick
1	3	154706		Håndtak	Handle	Steel + wood
1	4			Askehus	Ash house ,	Cast iron, min.4mm thick
		155719	4,5,45,48,56,57,59,61,68,69,72	Askehus komplett BP	Ash house comp. BP	Cast iron, min.4mm thick
		155720	4,5,45,48,56,57,59,61,68,69,72	Askehus komplett BBE	Ash house comp. BBE	Cast iron, min.4mm thick
		155721	4,5,45,48,56,57,59,61,68,69,72	Askehus komplett OGE	Ash house comp. OGE	Cast iron, min.4mm thick
		155722	4,5,45,48,56,57,59,61,68,69,72	Askehus komplett IVE	Ash house comp. IVE	Cast iron, min.4mm thick
		156173	4,5,45,48,56,57,59,61,68,69,72	Askehus komplett GRE	Ash house comp. GRE	Cast iron, min.4mm thick
		156329	4,5,45,48,56,57,59,61,68,69,72	Askehus komplett BRM	Ash house comp. BRM	Cast iron, min.4mm thick
		156547	4,5,45,48,56,57,59,61,68,69,72	Askehus komplett BLM	Ash house comp. BLM	Cast iron, min.4mm thick
1	5			Askedør BP	Ash door , BP	Cast iron, min.4mm thick
1	6	153776	2,6	Røyktut BP	Smoke outlet , BP	Cast iron, min.4mm thick
1	6	153772	2,6	Røyktut BBE	Smoke outlet , BBE	Cast iron, min.4mm thick
1	6	153774	2,6	Røyktut OGE	Smoke outlet , OGE	Cast iron, min.4mm thick
1	6	153773	2,6	Røyktut IVE	Smoke outlet , IVE	Cast iron, min.4mm thick
1	6	153775	2,6	Røyktut , IBE	Smoke outlet , IBE	Cast iron, min.4mm thick
1	6	156128	2,6	Røyktut , GRE	Smoke outlet , GRE	Cast iron, min.4mm thick
1	6	156326	2,6	Røyktut , BRM	Smoke outlet , BRM	Cast iron, min.4mm thick
1	6	156535	2,6	Røyktut , BLM	Smoke outlet , BLM	Cast iron, min.4mm thick
1	7	10332912		Fyrrist	Fire grate	Cast iron, min.4mm thick
4	8	10333292		Ben BP	Leg , BP	Cast iron, min.4mm thick
4	8	10333227		Ben BBE	Leg , BBE	Cast iron, min.4mm thick
4	8	10333232		Ben OGE	Leg , OGE	Cast iron, min.4mm thick
4	8	10333229		Ben IVE	Leg , IVE	Cast iron, min.4mm thick
4	8	10333236		Ben , IBE	Leg , IBE	Cast iron, min.4mm thick
4	8	10333246		Ben , GRE	Leg , GRE	Cast iron, min.4mm thick
4	8	10333247		Ben , BRM	Leg , BRM	Cast iron, min.4mm thick
4	8	10333248		Ben , BLM	Leg , BLM	Cast iron, min.4mm thick
1	9	10334292		Pyntedeksel side BP	Decorative cover side , BP	Cast iron, min.4mm thick
1	9	10334227		Pyntedeksel side BBE	Decorative cover side , BBE	Cast iron, min.4mm thick
1	9	10334232		Pyntedeksel side OGE	Decorative cover side , OGE	Cast iron, min.4mm thick
1	9	10334229		Pyntedeksel side IVE	Decorative cover side , IVE	Cast iron, min.4mm thick
1	9	10334236		Pyntedeksel side , IBE	Decorative cover side , IBE	Cast iron, min.4mm thick
1	9	10334246		Pyntedeksel side , GRE	Decorative cover side , GRE	Cast iron, min.4mm thick
1	9	10334247		Pyntedeksel side , BRM	Decorative cover side , BRM	Cast iron, min.4mm thick
1	9	10334248		Pyntedeksel side , BLM	Decorative cover side , BLM	Cast iron, min.4mm thick
1	10	155702	10,44,45,46,57,60,61,62,63,70,74,88	Dør høyre u/glass,Ver 3 BP	Door right w/o glass, Ver 3 BP	Cast iron, min.4mm thick
1	10	155704	10,44,45,46,57,60,61,62,63,70,74,88	Dør høyre u/glass Ver 3 BBE	Door right w/o glass, Ver 3 BBE	Cast iron, min.4mm thick
1	10	155706	10,44,45,46,57,60,61,62,63,70,74,88	Dør høyre u/glass Ver 3 OGE	Door right w/o glass, Ver 3 OGE	Cast iron, min.4mm thick
1	10	155708	10,44,45,46,57,60,61,62,63,70,74,88	Dør høyre u/glass Ver 3 IVE	Door right w/o glass, Ver 3 IVE	Cast iron, min.4mm thick
1	10	156180	10,44,45,46,57,60,61,62,63,70,74,88	Dør høyre u/glass Ver 3 GRE	Door right w/o glass, Ver 3 GRE	Cast iron, min.4mm thick
1	10	156352	10,44,45,46,57,60,61,62,63,70,74,88	Dør høyre u/glass Ver 3 BRM	Door right w/o glass, Ver 3 BRM	Cast iron, min.4mm thick
1	10	156553	10,44,45,46,57,60,61,62,63,70,74,88	Dør høyre u/glass Ver 3 BLM	Door right w/o glass, Ver 3 BLM	Cast iron, min.4mm thick
1	11	155703	11,44,46,60,63,70,73,74,88	Dør venstre u/glass, Ver 3 BP	Door left w/o glass, Ver 3 BP	Cast iron, min.4mm thick
1	11	155705	11,44,46,60,63,70,73,74,88	Dør venstre u/glass, Ver 3 BBE	Door left w/o glass, Ver 3 BBE	Cast iron, min.4mm thick
1	11	155707	11,44,46,60,63,70,73,74,88	Dør venstre u/glass, Ver 3 OGE	Door left w/o glass, Ver 3 OGE	Cast iron, min.4mm thick
1	11	155709	11,44,46,60,63,70,73,74,88	Dør venstre u/glass, Ver 3 IVE	Door left w/o glass, Ver 3 IVE	Cast iron, min.4mm thick

Jøtul F 600 Versjon 3

Jøtul F 600 BP cat.no. 350775, BBE-cat.no. 350776, OGE-cat.no. 350777, IVE-cat.no. 350778, GRE-cat.no. 350931, BRM- cat. no. 351111, BLM-cat nn.351126

Antall Number	Pos. nr Item no	Reservedeler Spareparts	Consist of pos no.	Benevnelse	Description	Dim./Spec.
1	11	156181	11,44,46,60,63,70,73,74,88	Dør venstre u/glass, Ver 3 GRE	Door left w/o glass, Ver 3 GRE	Cast iron, min.4mm thick
1	11	156353	11,44,46,60,63,70,73,74,88	Dør venstre u/glass, Ver 3 BRM	Door left w/o glass, Ver 3 BRM	Cast iron, min.4mm thick
1	11	156554	11,44,46,60,63,70,73,74,88	Dør venstre u/glass, Ver 3 BLM	Door left w/o glass, Ver 3 BLM	Cast iron, min.4mm thick
1	12	10388492		Bunn BP	Bottom , BP	Cast iron, min.4mm thick
1	12	10388427		Bunn BBE	Bottom , BBE	Cast iron, min.4mm thick
1	12	10388432		Bunn OGE	Bottom , OGE	Cast iron, min.4mm thick
1	12	10388429		Bunn IVE	Bottom , IVE	Cast iron, min.4mm thick
1	12	10388446		Bunn GRE	Bottom , GRE	Cast iron, min.4mm thick
1	12	10388447		Bunn BRM	Bottom , BRM	Cast iron, min.4mm thick
1	12	10388448		Bunn BLM	Bottom , BLM	Cast iron, min.4mm thick
1	13	10388512		Innerbunn, fremre del	Inner bottom, front part	Cast iron, min.4mm thick
1	14	10388612		Innerbunn, bakre del	Inner bottom, rear part	Cast iron, min.4mm thick
1	15	10388792		Bakstykke BP	Rear plate , BP	Cast iron, min.4mm thick
1	15	10388727		Bakstykke BBE	Rear plate , BBE	Cast iron, min.4mm thick
1	15	10388732		Bakstykke OGE	Rear plate , OGE	Cast iron, min.4mm thick
1	15	10388729		Bakstykke IVE	Rear plate , IVE	Cast iron, min.4mm thick
1	15	10388746		Bakstykke GRE	Rear plate , GRE	Cast iron, min.4mm thick
1	15	10388747		Bakstykke BRM	Rear plate , BRM	Cast iron, min.4mm thick
1	15	10388748		Bakstykke BLM	Rear plate , BLM	Cast iron, min.4mm thick
1	17	10388912		Kanal	Air manifold	Cast iron, min.4mm thick
1	18	10389092		Front BP	Front , BP	Cast iron, min.4mm thick
	18	10389027		Front BBE	Front , BBE	Cast iron, min.4mm thick
	18	10389032		Front OGE	Front , OGE	Cast iron, min.4mm thick
	18	10389029		Front IVE	Front , IVE	Cast iron, min.4mm thick
	18	10389046		Front GRE	Front , GRE	Cast iron, min.4mm thick
	18	10389047		Front BRM	Front , BRM	Cast iron, min.4mm thick
	18	10389048		Front BLM	Front , BLM	Cast iron, min.4mm thick
1	19	155691		Innerfront	Inner front	Cast iron, min.4mm thick
1	20	10389292		Side høyre BP	Side right , BP	Cast iron, min.4mm thick
1	20	10389227		Side høyre BBE	Side right , BBE	Cast iron, min.4mm thick
1	20	10389232		Side høyre OGE	Side right , OGE	Cast iron, min.4mm thick
1	20	10389229		Side høyre IVE	Side right , IVE	Cast iron, min.4mm thick
1	20	10389246		Side høyre GRE	Side right , GRE	Cast iron, min.4mm thick
1	20	10389247		Side høyre BRM	Side right , BRM	Cast iron, min.4mm thick
1	20	10389248		Side høyre BLM	Side right , BLM	Cast iron, min.4mm thick
1	21	10389392		Side venstre BP	Side left , BP	Cast iron, min.4mm thick
1	21	10389327		Side venstre BBE	Side left , BBE	Cast iron, min.4mm thick
1	21	10389332		Side venstre OGE	Side left , OGE	Cast iron, min.4mm thick
1	21	10389329		Side venstre IVE	Side left , IVE	Cast iron, min.4mm thick
1	21	10389346		Side venstre GRE	Side left , GRE	Cast iron, min.4mm thick
1	21	10389347		Side venstre BRM	Side left , BRM	Cast iron, min.4mm thick
1	21	10389348		Side venstre BLM	Side left , BLM	Cast iron, min.4mm thick
1	22	10389492		Askeleppe front BP	Ash lip front , BP	Cast iron, min.4mm thick
1	22	10389427		Askeleppe front BBE	Ash lip front , BBE	Cast iron, min.4mm thick
1	22	10389432		Askeleppe front OGE	Ash lip front , OGE	Cast iron, min.4mm thick
1	22	10389429		Askeleppe front IVE	Ash lip front , IVE	Cast iron, min.4mm thick
1	22	10389446		Askeleppe front GRE	Ash lip front , GRE	Cast iron, min.4mm thick

Jøtul F 600 Versjon 3

Jøtul F 600 BP cat.no. 350775, BBE-cat.no. 350776, OGE-cat.no. 350777, IVE-cat.no. 350778, GRE-cat.no. 350931, BRM- cat. no. 351111, BLM-cat nn.351126

Antall Number	Pos. nr Item no	Reservedeler Spareparts	Consist of pos no.	Benevnelse	Description	Dim./Spec.
1	22	10389447		Askeleppe front BRM	Ash lip front , BRM	Cast iron, min.4mm thick
1	22	10389448		Askeleppe front BLM	Ash lip front , BLM	Cast iron, min.4mm thick
1	23	154569	23,71	Topp BP	Top , BP	Cast iron, min.4mm thick
1	23	154570	23,71	Topp BBE	Top , BBE	Cast iron, min.4mm thick
1	23	154571	23,71	Topp OGE	Top , OGE	Cast iron, min.4mm thick
1	23	154572	23,71	Topp IVE	Top , IVE	Cast iron, min.4mm thick
1	23	156182	23,71	Topp GRE	Top , GRE	Cast iron, min.4mm thick
1	23	156355	23,71	Topp BRM	Top , BRM	Cast iron, min.4mm thick
1	23	156556	23,71	Topp BLM	Top , BLM	Cast iron, min.4mm thick
1	24			Rørholder øvre høyre	Tube holder upper right	Cast iron, min.4mm thick
1	25			Rørholder øvre venstre	Tube holder upper left	Cast iron, min.4mm thick
1	26			Rørholder nedre høyre	Tube holder bottom right	Cast iron, min.4mm thick
1	27			Rørholder nedre venstre	Tube holder bottom left	Cast iron, min.4mm thick
1	28	10400018		Inspeksjonsluke	Inspection cover	Cast iron, min.4mm thick
1	29	155714	29,30,45,50,55,57,61,75,91,92,93,99	Sidedør BP	Side door , BP	Cast iron, min.4mm thick
1	29	155715	29,30,45,50,55,57,61,75,91,92,93,99	Sidedør BBE	Side door , BBE	Cast iron, min.4mm thick
1	29	155716	29,30,45,50,55,57,61,75,91,92,93,99	Sidedør OGE	Side door , OGE	Cast iron, min.4mm thick
1	29	155717	29,30,45,50,55,57,61,75,91,92,93,99	Sidedør IVE	Side door , IVE	Cast iron, min.4mm thick
1	29	156179	29,30,45,50,55,57,61,75,91,92,93,99	Sidedør GRE	Side door , GRE	Cast iron, min.4mm thick
1	29	156351	29,30,45,50,55,57,61,75,91,92,93,99	Sidedør BRM	Side door , BRM	Cast iron, min.4mm thick
1	29	156552	29,30,45,50,55,57,61,75,91,92,93,99	Sidedør BLM	Side door , BLM	Cast iron, min.4mm thick
1	30	10400212		Brennplate sidedør	Burnplate side door	Cast iron, min.4mm thick
1	31	10400312		Brennplate venstre	Burnplate left	Cast iron, min.4mm thick
2	32	10400412		Brennplate bak	Burnplate rear	Cast iron, min.4mm thick
1	33	10400592		Askeleppe side BP	Ash lip side , BP	Cast iron, min.4mm thick
1	33	10400527		Askeleppe side BBE	Ash lip side , BBE	Cast iron, min.4mm thick
1	33	10400532		Askeleppe side OGE	Ash lip side , OGE	Cast iron, min.4mm thick
1	33	10400529		Askeleppe side IVE	Ash lip side , IVE	Cast iron, min.4mm thick
1	33	10400546		Askeleppe side GRE	Ash lip side , GRE	Cast iron, min.4mm thick
1	33	10400547		Askeleppe side BRM	Ash lip side , BRM	Cast iron, min.4mm thick
1	33	10400548		Askeleppe side BLM	Ash lip side , BLM	Cast iron, min.4mm thick
1	34	10400616		Ventil	Air valve	Cast iron, min.4mm thick
2	35	10400712		Hvelv	Baffle plate	Cast iron, min.4mm thick
1	36	154574	36,89	Toppdeksel BP	Top cover	Cast iron, min.4mm thick
1	36	154575	36,89	Toppdeksel BBE	Top cover , BBE	Cast iron, min.4mm thick
1	36	154576	36,89	Toppdeksel OGE	Top cover , OGE	Cast iron, min.4mm thick
1	36	154577	36,89	Toppdeksel IVE	Top cover , IVE	Cast iron, min.4mm thick
1	36	156183	36,89	Toppdeksel GRE	Top cover , GRE	Cast iron, min.4mm thick
1	36	156354	36,89	Toppdeksel BRM	Top cover , BRM	Cast iron, min.4mm thick
1	36	156555	36,89	Toppdeksel BLM	Top cover , BLM	Cast iron, min.4mm thick
	36	351105		Kleber toppdeksel ekstrautstyr	Soap stone top cover extra	Soap stone
5	37	116832		Mutter rustfri	Nut stainless	M6
2	38	117876		Skrue krave m8x25	Screw collar hexagon m8x25	M8x25mm
7	39	117097		Skrue sekskant	Screw hexagon	M6x50
4	40	117099		Skrue krave	Screw collar hexagon	M6x25mm
9	41	117118		Skrue krave	Screw collar hexagon	M6x16mm
2	42	117120		Skrue selvgjengende	Screw selfthread	M6

Jøtul F 600 Versjon 3

Jøtul F 600 BP cat.no. 350775, BBE-cat.no. 350776, OGE-cat.no. 350777, IVE-cat.no. 350778, GRE-cat.no. 350931, BRM- cat. no. 351111, BLM-cat nn.351126

Antall Number	Pos. nr Item no	Reservedeler Spareparts	Consist of pos no.	Benevnelse	Description	Dim./Spec.
2	43	117129		Skrue krave	Screw collar hexagon	M6x10 mm
4	44	117130		Skrue krave	Screw collar hexagon	M6x12mm
2	45	117177		Mutter	Nut Hexagon	M10
8	46	117505		Skrue panh. (front dør)	Screw panh. (front door)	M6x8 DIN 934
1	47	117120		Skive	Washer	Ø6x12x0,5 mm
1	48	220852		Låsebolt askedør	Latch bolt ash door	Ø10mm Steel
	48	155713	45,48,56,57,59,61	Håndtak askedør komplett	Handle ash door complete	
1	49	117792		Skrue innv. sekskant	Screw allen	M8x25mm
3	50	117818		Skrue seksk rustfri	Screw hexagon stainless	M6x16mm DIN 933 A4-80
1	51	117873		Skrue krave	Screw collar hexagon	M8x12mm
1	52	117874		Skrue krave	Screw collar hexagon	M8x16mm
12	53	117877		Skrue krave	Screw collar hexagon	M8x30mm
2	54	117880		Mutter krave	Nut collar hexagon	M6
23	55	120004		Skive	Washer	Ø6.4x18x1.6mm
1	56	155738	56,59	Treknott askedør	Wooden knob ash door	Hard wood
3	57	126164		Fjær for låsskrue	Spring for latch bolt	2mm Stainless steel
2	58	127075		Hengsel dubb front/sidedør Sort kromat	Hinge pin front/side door , Black cromat	Ø6mm
2	58	125960		Hengsel dubb forniklet	Hinge pin front/side door, nickel cromat	Ø6mm
1	59			Skrue sylinderrhode	Screw syl. Head	M6x60
1	60			Pakning (høyre dør mot front)	Gasket (right door to front)	LD -375-2 Ø9,5(3/8")x900mm
1	60			Pakning (venstre dør motfront)	Gasket (left door to front)	LD -375-2 Ø9,5(3/8")x900mm
3	61	128011		Stengejern	Latch	3mm Stainless steel
2	62	128359		Låsskrue	Latch bolt	Ø10mm Steel
8	63	128361		Glassklips	Glass clip	1mm Stainless steel
1	64	128362		Askeskuff	Ash pan	1mm steel plate
1	65	10026275	Replaced by kit 12047020 from April 2021	Hendel for luftventil	Handle for air vent	Ø5mm Steel
1	68	128408		Hengselbolt, askedør	Hinge pin, ash door	Ø8mm Steel
1	69			Pakning (Askedør)	Gasket (ashdoor)	LD -250-2 Ø6.4(1/4")x1100mm
1	69	410761		Pakning (askedør)	Gasket (ash door)	LD-375-2 Ø9,5(3/8")x1100mm(5000mm)
2	70			Pakning (glass)	Gasket (glass)	LD-250 Ø6,4(1/4")x1050mm
1	71			Pakning (topp)	Gasket (top)	LD -375-2 Ø9,5(3/8")x2100
1	72			Pakning (askehus)	Gasket (ash house)	LD-250 Ø6,4(1/4")x1300
1	73			Pakning (venstre dør mot midten)	Gasket (left door middle)	LD-250 Ø6,4(1/4")x410mm
2	74	128934		Hylse for hengsel	Sleeve for door hinge	Ø10xØ6,2x10mm
1	75			Pakning (sidedør)	Gasket (side door)	LD-375-2 Ø9.5(3/8")x1400mm
1	76			Pakning (røyk tut)	Gasket (Smoke outlet)	LD-250 Ø6,4(1/4")x930mm
1	77			Rør nr 1 fra front	Tube first from front	Ø22,2mm Stainless steel tube
1	78			Rør nr 2 fra front	Tube second from front	Ø22,2mm Stainless steel tube
1	79			Rør nr 3 fra front	Tube third from front	Ø22,2mm Stainless steel tube
1	80			Rør nr 4 fra front	Tube forth from front	Ø22,2mm Stainless steel tube
1	82	154330		Skjermplate under USA	Bottom heatshield USA	Ø0,9mm steel plate
1	82	129192		Skjermplate under EUR	Bottom heatshield EUR	Ø0,9mm steel plate
	83			Skjermplate røykuttak	Heatshield top exit	Ø0,9mm steel plate
1	84	154329	83,84	Skjermplate bak+ røykuttak	Rear heatshield+ top exit	
	84			Skjermplate bak	Rear heatshield	Ø0,9mm steel plate
1	85	129284		Luftbegrenser	Air restrictor	1,0mm steel plate
1	86	129506		Isolasjonsmatte	Insulation blanket	720x360x13mm

Jøtul F 600 Versjon 3

Jøtul F 600 BP cat.no. 350775, BBE-cat.no. 350776, OGE-cat.no. 350777, IVE-cat.no. 350778, GRE-cat.no. 350931, BRM- cat. no. 351111, BLM-cat nn.351126

Antall Number	Pos. nr Item no	Reservedeler Spareparts	Consist of pos no.	Benevnelse	Description	Dim./Spec.
1	87	128357		Glass høyre	Glass right	4mm ceramic glass
1	87	128419		Glass venstre	Glass left	4mm ceramic glass
2	88	220120		Hengsel ny	Front door hinge	4mm steel + ø6steel pins
1	89			Pakning (toppdeksel)	Gasket (top cover)	LD -360 Ø8,7(11\32")x1050mm
2	90	220270		Låsering Ø6 X Ø12 X 6 mm	Shaft collar Ø6 X Ø12 X 6 mm	Ø6 X Ø12 X 6 mm Steel
1	91	220853		Låsebolt sidedør	Latch bolt side door	ø10,0mm steel
1	92	117587		Skive	Washer	Ø10,5xØ25x1,5
1	93			Klinke forniklet	Latch nick chromed	Cast iron, min.4mm thick
1	93			Klinke Sort	Latch nick black	Cast iron, min.4mm thick
1	94			Skive	Washer	Ø6,4xØ12,5x1,6
1	95	124853		Skive klingerit	Washer, insulating	ø22xø8,2x2mm
1	96			Treknott sidedør	Wooden knob side door	Hard wood
	96	151991	37,94,95,96,97,98	Treknott med smådeler	Wooden knob w\small parts	
1	97	126229		Distansehylse sidedør	Distance sleeve for side door	ø8xø6x27,5mm
1	98			Skrue pan hode	Skrue pan head	M6x40
1	99	117733		Spennstift	Pin	ø5x24
1	100	154401	24,25,26,27,39,55,77,78,79,80	Luftkammer komplett	Air chamber complete	
	101	155711	37,45,57,61,91,92,93,94,95,96,97,9899	Håndtak sidedør komplett BP	Handle side door complete BP	
	101	155712	37,45,57,61,91,92,93,94,95,96,97,9899	Håndtak sidedør komplett, forniklet	Handle side door complete nickel plated	
1	102	221032		Adapter lufttilførsel	Adaptor outside air	0,75mm Alum \ aluzn
1				Sett for tilkobling av uteluft (USA/Canada)	Outside air kit(Only USA/Canada)	
1				Sett for å feste ovn til golv (USA/Canada)	Floor bracket kit(Only USA/Canada)	
1				Gnistfanger (USA/Canada)	Fire screen (Only USA/Canada)	
1		129077		Skiltholder	Stand off shield	1,5mm steel plate
4		117087		Nagle	Rivet	2.4x4mm
2		117894		Nagle	Rivet	4x12mm
1		150861		Boks med korrekturlakk, BP	Box with touch up paint, BP	
1		127254		Flaske med korrekturlakk, BBE	Bottle of touch up paint, BBE	
1		128543		Flaske med korrekturlakk, OGE	Bottle of touch up paint, oge	
1		126061		Flaske med korrekturlakk, IVE	Bottle of touch up paint, IVE	
1		128098		Flaske med korrekturlakk, , IBE	Bottle of touch up paint, IBE	
						Tegn.nr. 4-3494-P28